

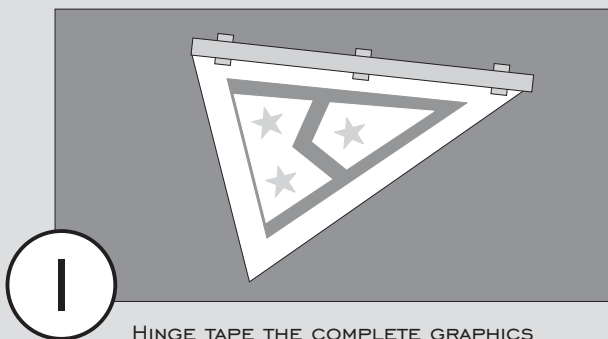

APPLICATION INSTRUCTIONS

GENERAL INSTRUCTIONS

- A. YOU WILL NOTICE THAT THE BURGEES ARE SANDWICHED BETWEEN A SILICONE BACKING PAPER AND A LIGHTLY ADHESIVE LIFTING PAPER.
- B. APPLY YOUR BURGEES AT TEMPERATURES ABOVE 50 DEGREES F.
- C. DO NOT APPLY YOUR BURGEES ON A WINDY DAY.
- D. MAKE SURE THE AREA WHERE YOU APPLY THE BURGEE IS FREE OF SOIL, GREASE, AND WAX. MANY NEW FIBERGLAS SURFACES ARE COVERED WITH MOLD RELEASE WAX, THIS MUST ALSO BE REMOVED.



1 HINGE TAPE THE COMPLETE GRAPHICS PACKAGE (FACE UP) INTO POSITION WITH PIECES OF MASKING TAPE

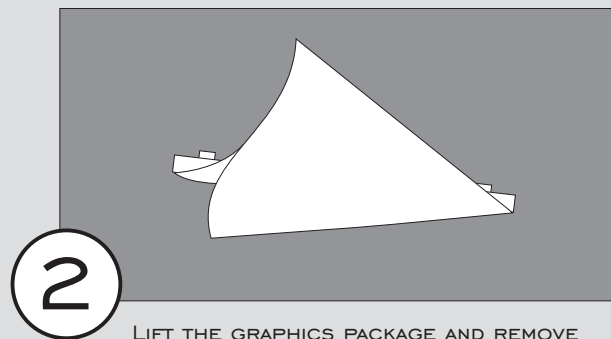

2 LIFT THE GRAPHICS PACKAGE AND REMOVE THE SILICONE BACKING PAPER.....DO NOT ALLOW ANY FOREIGN MATERIAL TO TOUCH THE ADHESIVE SIDE OF THE GRAPHIC.....SLOWLY PLACE THE GRAPHIC DOWN ONTO THE APPLICATION SURFACE



3 SQUEEGEE THE ENTIRE SURFACE USING THE EDGE OF A CREDIT CARD

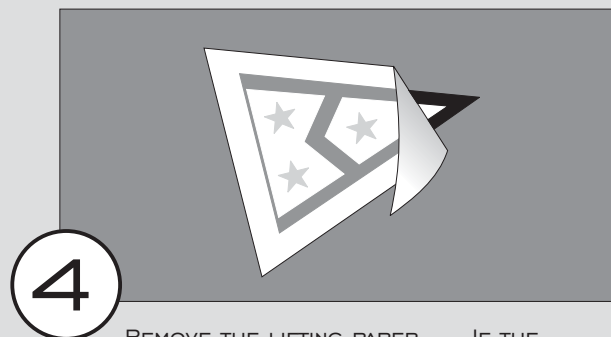

4 REMOVE THE LIFTING PAPER.....IF THE BURGEE LIFTS WITH THE PAPER HOLD THE BURGEE DOWN WITH YOUR FINGER AND SLOWLY PEEL BACK THE APPLICATION PAPERIF AIR BUBBLES OCCUR, PUNCTURE WITH PIN AND SMOOTH DOWN WITH YOUR FINGER

IF YOU FIND IT NECESSARY TO REMOVE YOUR BURGEE AT A LATER DATE...HEAT THE VINYL WITH AN ELECTRIC HAIRDRYER OR HEAT GUN UNTIL IT'S WARM TO THE TOUCH. THE VINYL CAN NOW BE PULLED FROM THE APPLICATION SURFACE IN LARGE SECTIONS. ANY REMAINING ADHESIVE RESIDUE CAN BE REMOVED WITH DENATURATED ALCOHOL.